

**SITE PLAN FOR PROPOSED G + III STORIED RESIDENTIAL BUILDING PLAN U/S 393A OF KMC ACT 1980
COMPLYING K.M.C BUILDING RULE 2009 AT PREMISES NO - 111, DIAMOND PARK, WARD NO - 143,
BOROUGH NO - XVI, UNDER KOLKATA MUNICIPAL CORPORATION.**

1. AREA OF PLOT = 330.368 SQM. (AS PER B/ DECL.)
2. HEIGHT OF BUILDING = 12.450 M.
3. ROAD WIDTH = 6.096 M.
4. TOTAL FLOOR AREA = 714.934 SQM.

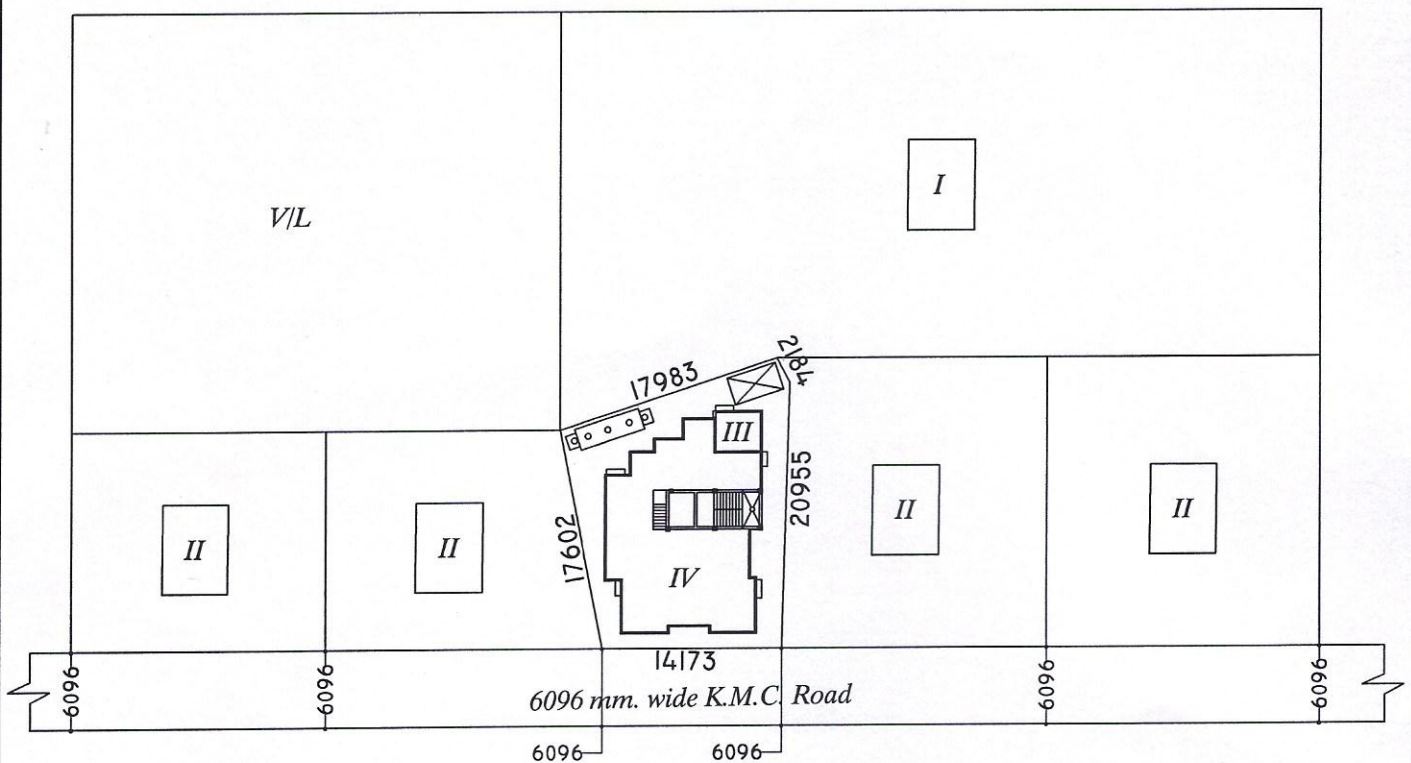
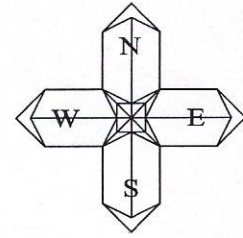

SITE PLAN

SCALE - 1:600

D. D. CONSTRUCTION & PROJECT

Dipak Kumar Halder

Proprietor

Sri Dipak Kumar Halder
Proprietor of D.D. Construction & Project
as C.A. of Sri Pradip Biswas, Sri Dilip Biswas,
Smt. Shikha Ghosh, Smt. Rekha Chowdhury,
Miss Kanika Biswas

SIGNATURE OF OWNERS / APPLICANTS

Akash Mondal

AKASH MONDAL
REGISTERED WITH COUNCIL
OF ARCHITECTURE
REGD. NO. CA/19/111545

AR. Akash Mondal
Regd. with Council of Architecture
Reg. no.: CA/19/111545

SIGNATURE OF ARCHITECT